

Connecting to Wnet - Windows 8

Right-click on your network

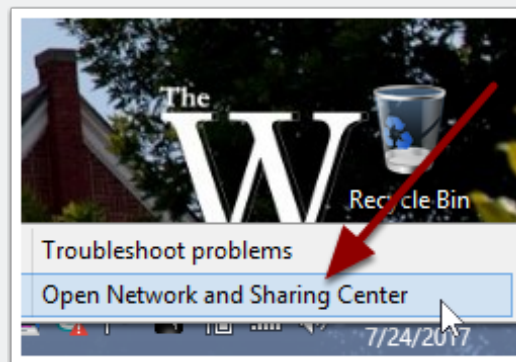

Select Open Network and Sharing Center



Connecting to Wnet - Windows 8

Select Set up a new connection or network

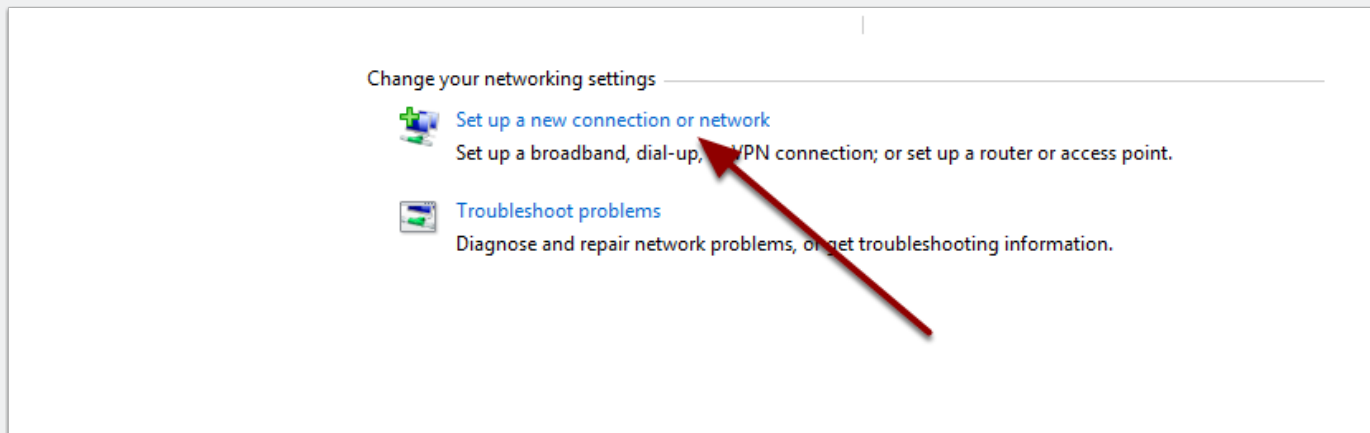

Connecting to Wnet - Windows 8

1. Select Manually connect to a wireless network
2. Click Next

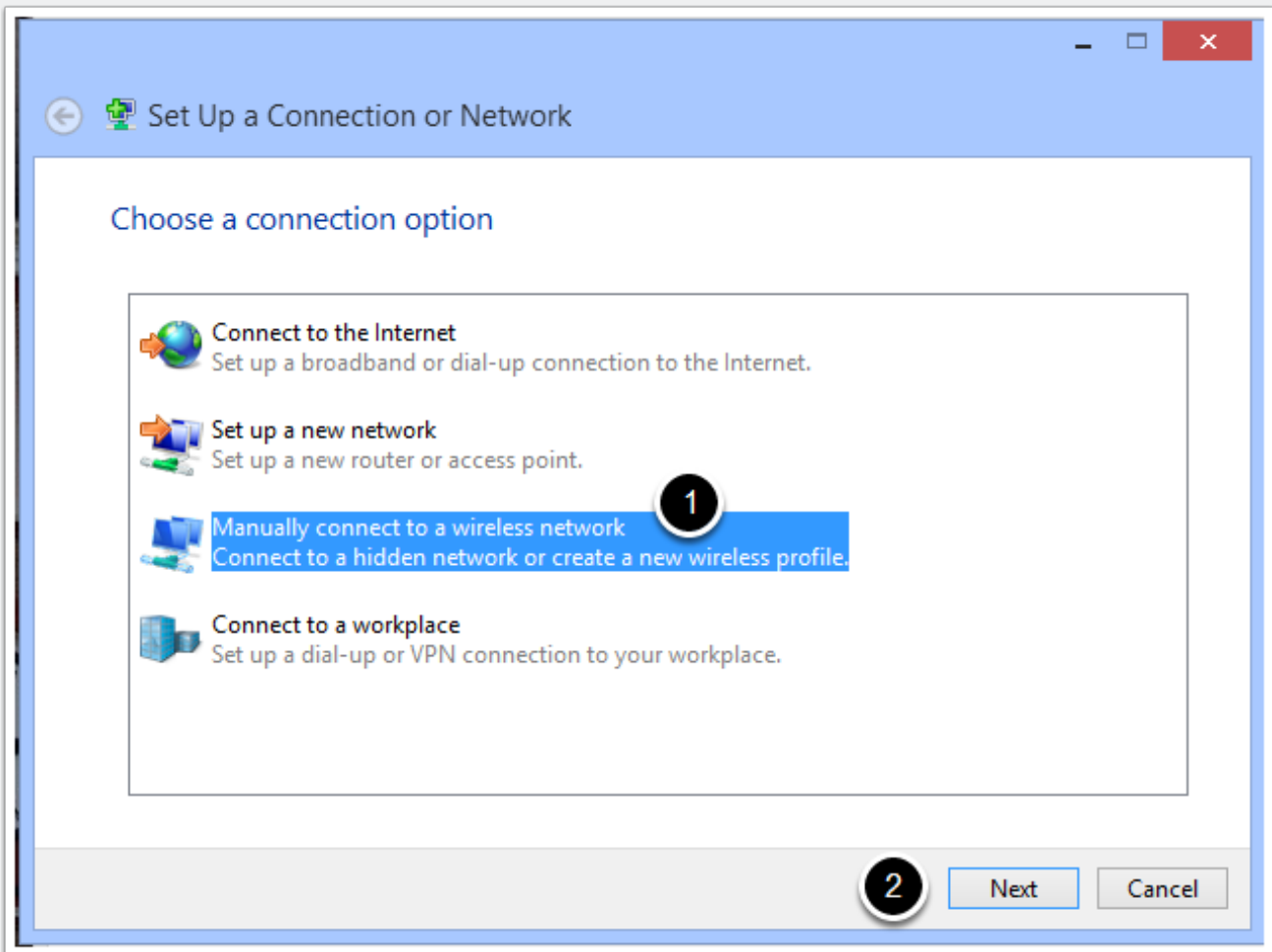

Connecting to Wnet - Windows 8

1. In the Network name field type Wnet
2. In the Security type drop down menu, select WPA2-Enterprise
3. In the Encryption type drop down menu, select AES
4. Click Next

Manually connect to a wireless network

Enter information for the wireless network you want to add

Network name: 1

Security type: 2

Encryption type: 3

Security Key: Hide characters

Start this connection automatically

Connect even if the network is not broadcasting

Warning: If you select this option, your computer's privacy might be at risk.

4

Connecting to Wnet - Windows 8

Select change connection settings

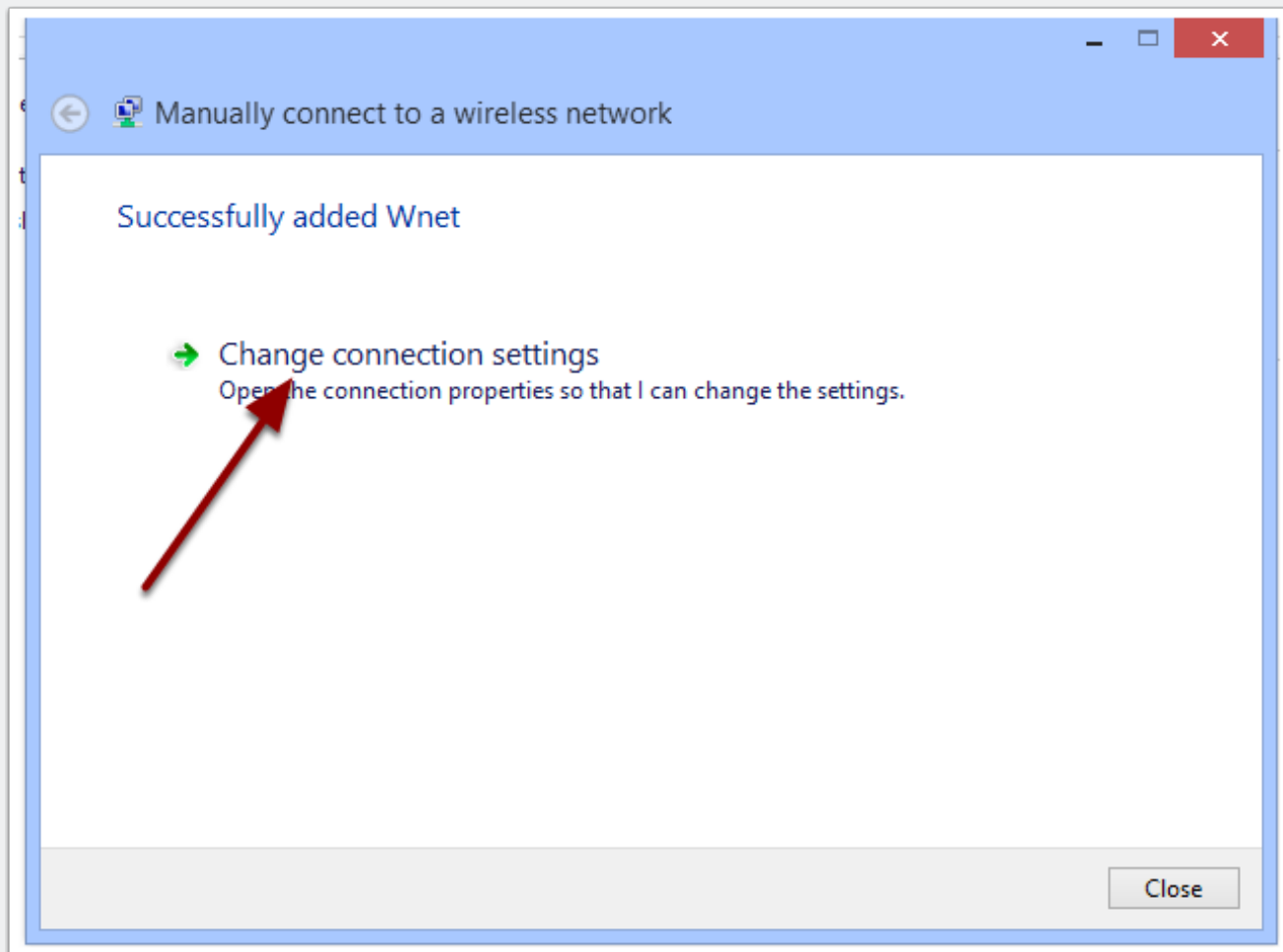

Connecting to Wnet - Windows 8

Select the Security tab

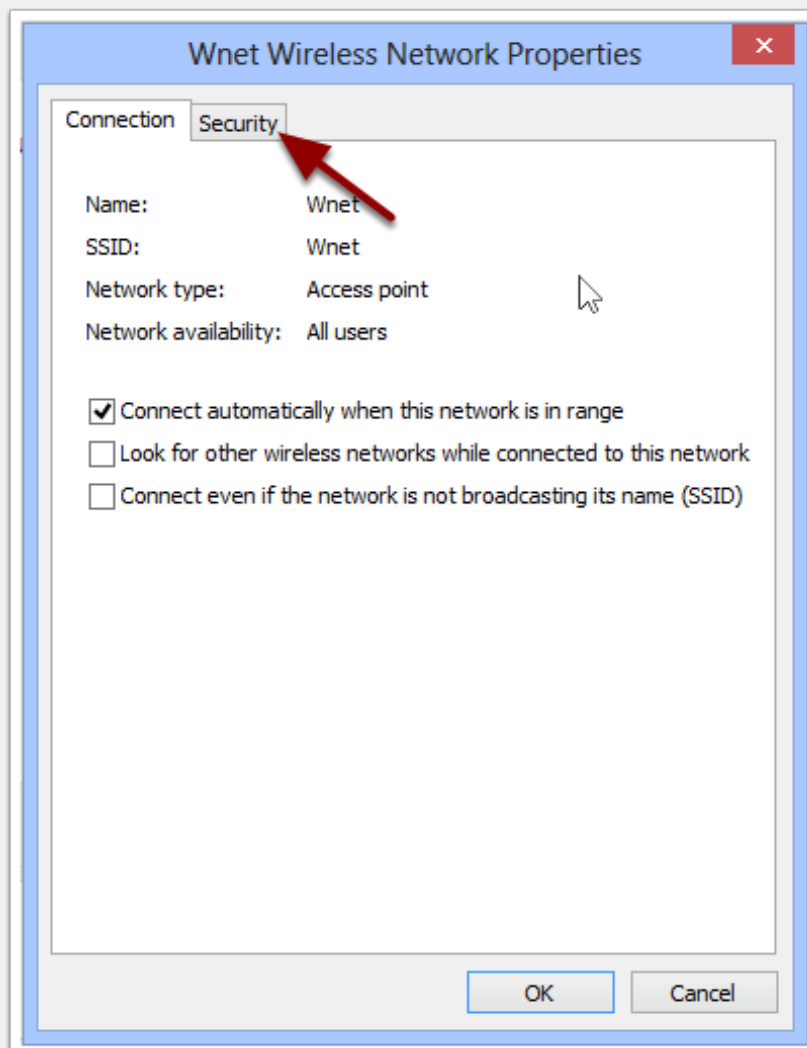

Connecting to Wnet - Windows 8

1. Ensure Microsoft: Protected EAP (PEAP) is selected in the drop down menu
2. Click the settings button

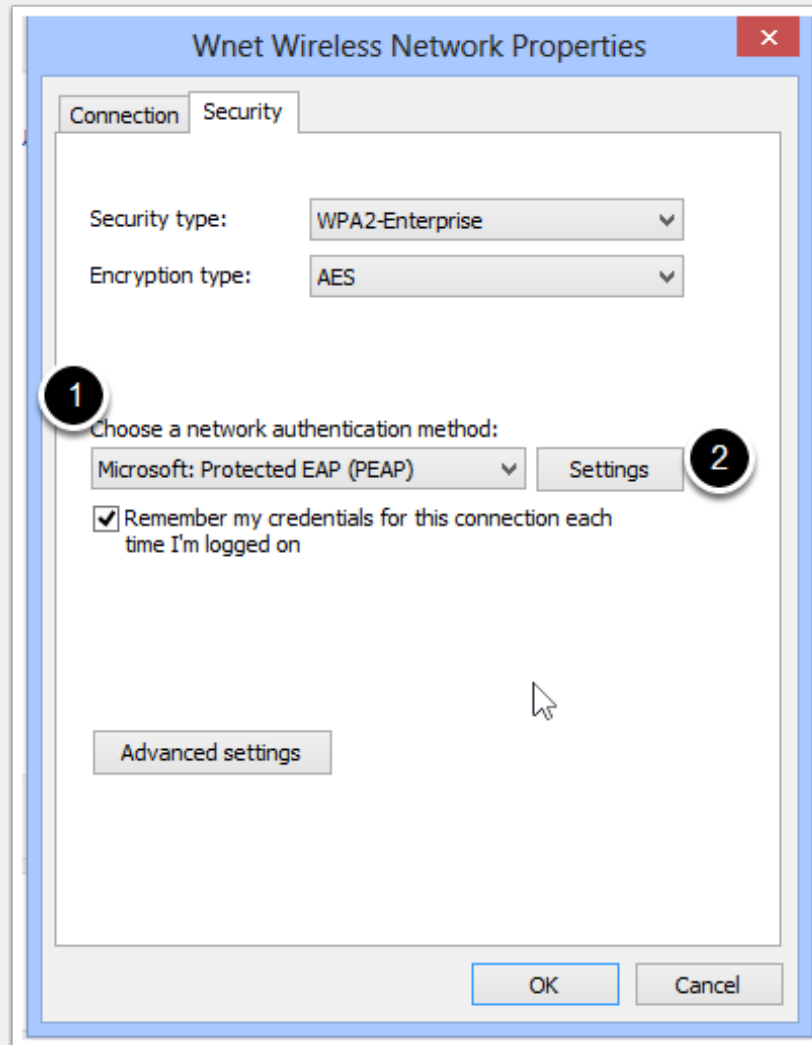

Connecting to Wnet - Windows 8

- 1. Uncheck the box that states Verify the server's identity by validating the certificate**
- 2. Ensure that Secured password (EAP-MSCHAP v2) is selected in the authentication method drop down menu**
- 3. Click the configure button**

Connecting to Wnet - Windows 8

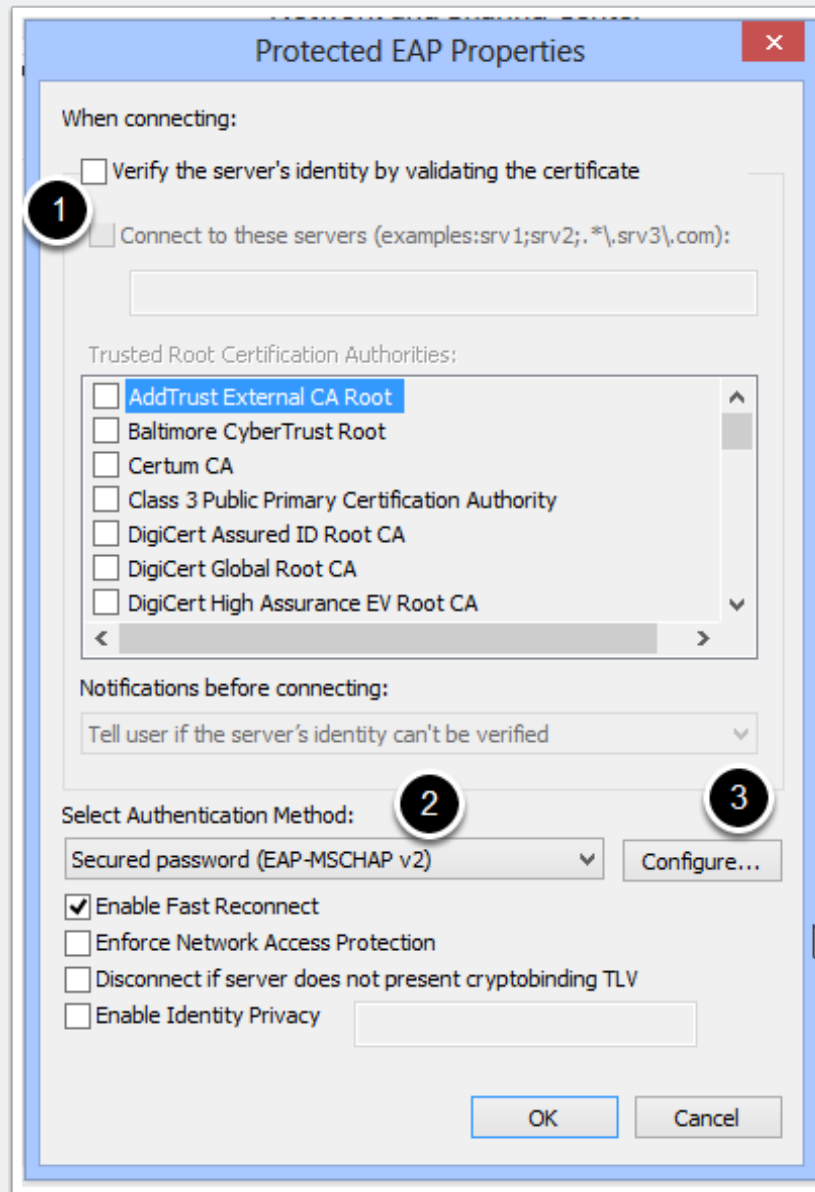

Connecting to Wnet - Windows 8

Uncheck the box that states *Automatically use my Windows logon name and password (and domain if any)*, and click OK

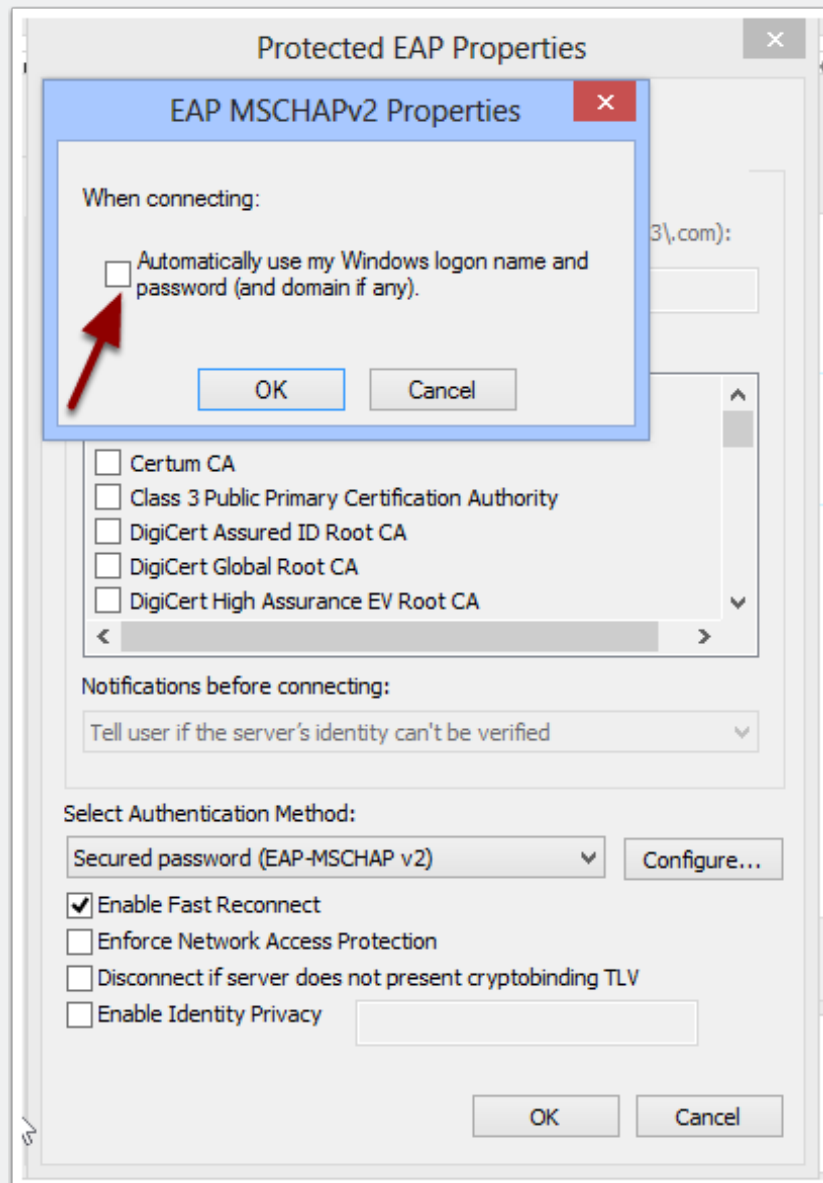

Connecting to Wnet - Windows 8

Click OK

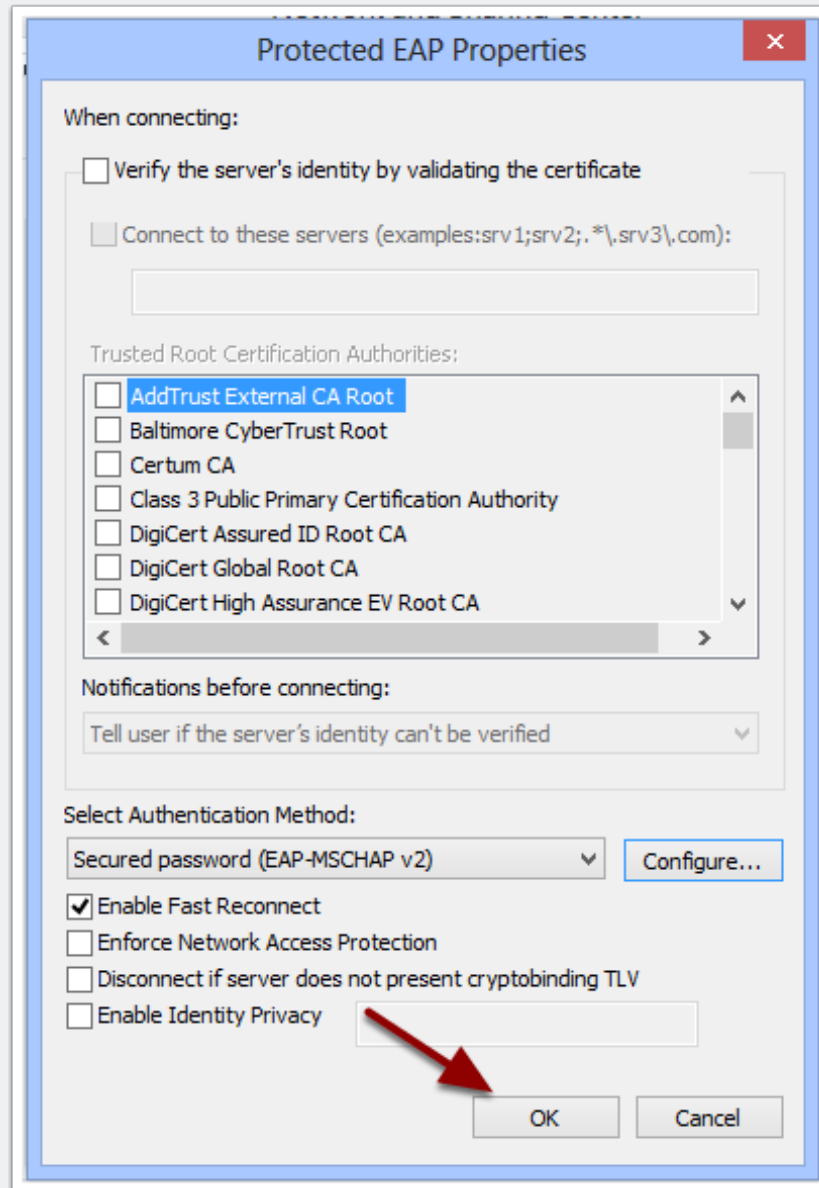

Connecting to Wnet - Windows 8

Click the Advanced Settings button

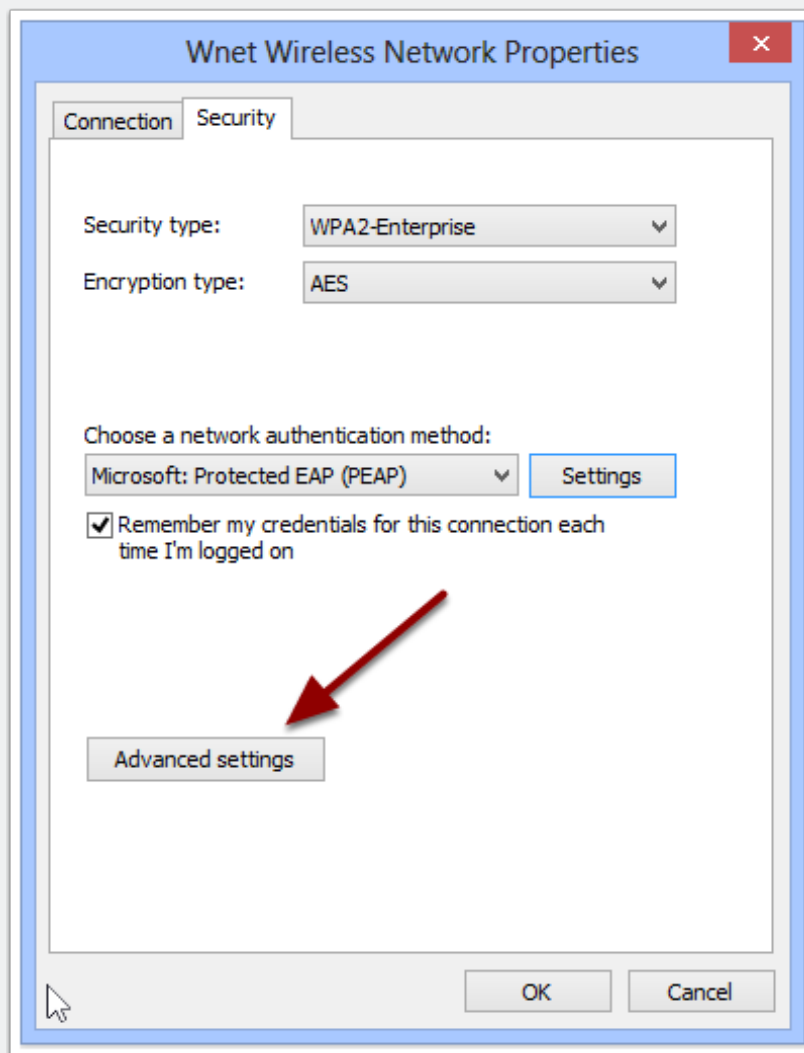

Connecting to Wnet - Windows 8

1. Check the box that states Specify authentication mode
2. Select User authentication from the drop down menu
3. Click OK

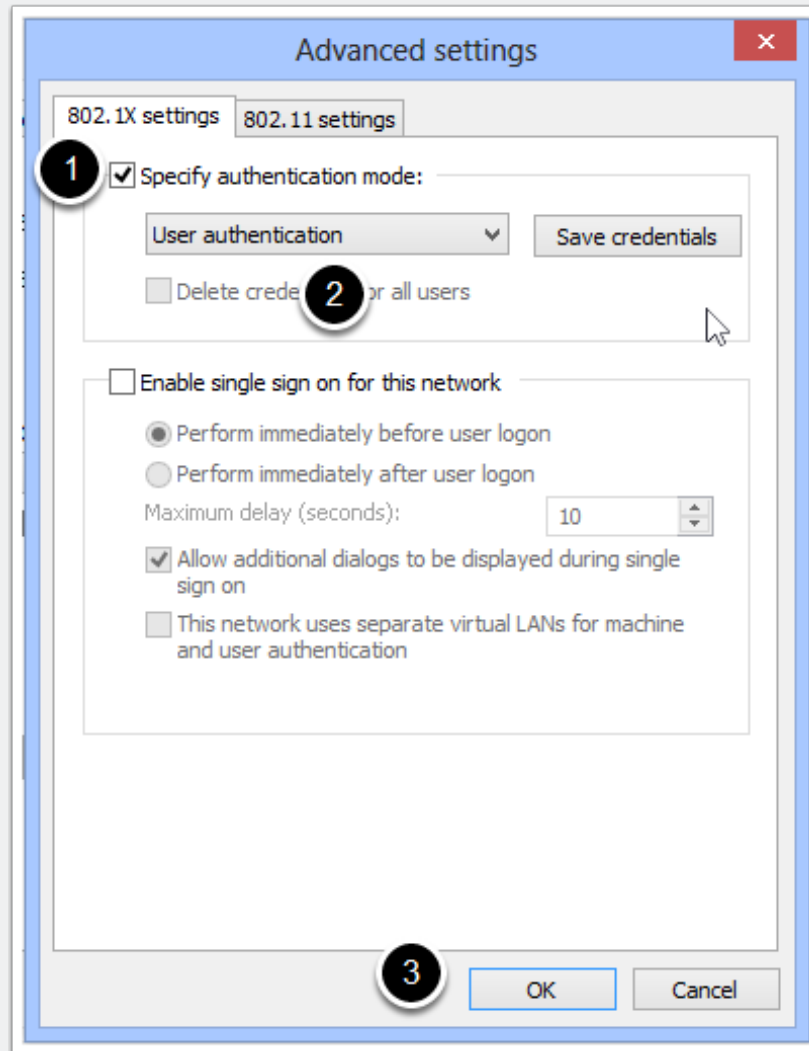

Connecting to Wnet - Windows 8

Click OK

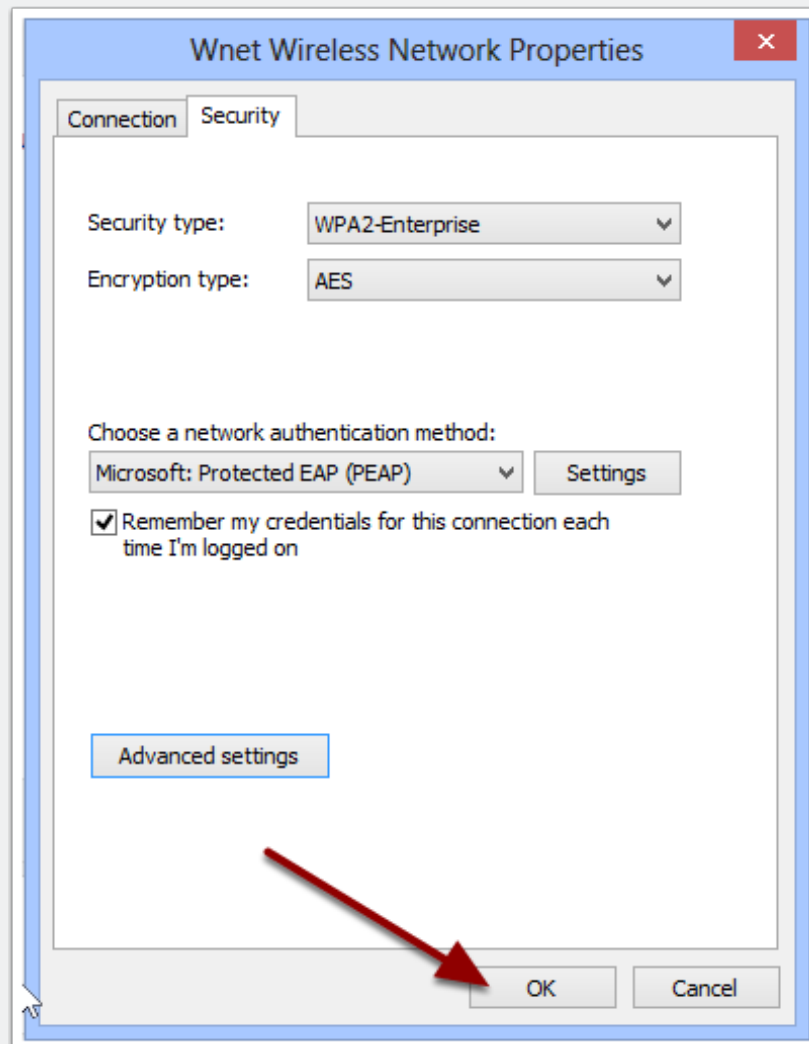

Connecting to Wnet - Windows 8

Click Close

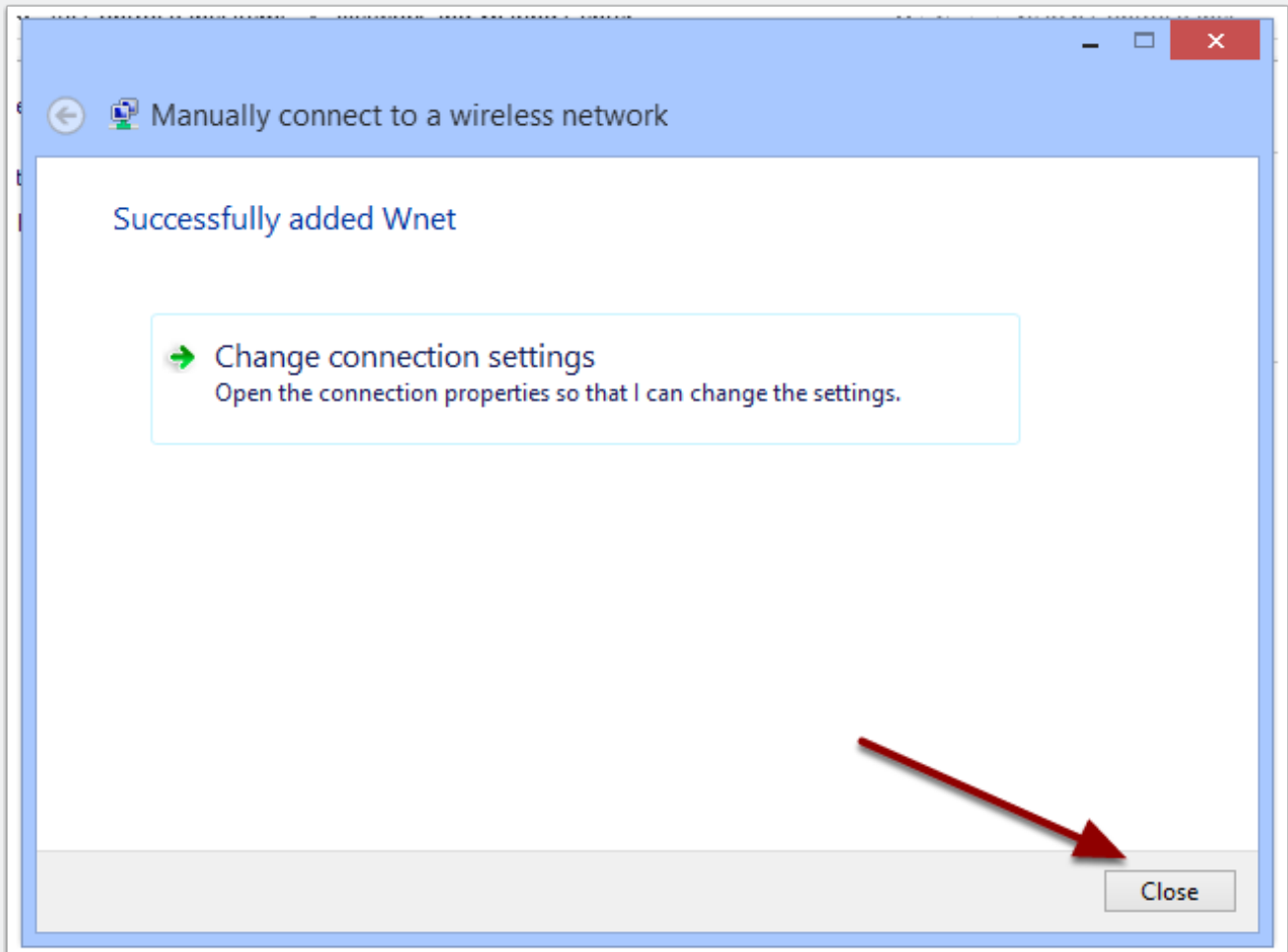

Connecting to Wnet - Windows 8

When you connect to Wnet, you will be prompted for your credentials, which are the same credentials you use to log into Portal

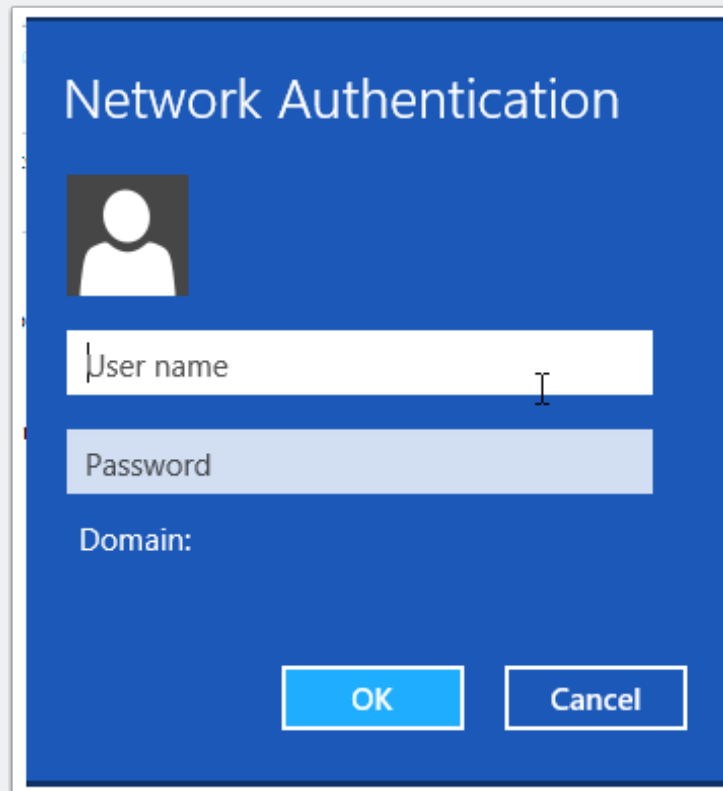

The image shows a 'Network Authentication' dialog box with a blue background. At the top, the title 'Network Authentication' is displayed in white. Below the title is a white silhouette icon of a person. There are three input fields: a 'User name' field with a cursor, a 'Password' field, and a 'Domain:' label followed by an empty field. At the bottom, there are two buttons: 'OK' and 'Cancel'.

That's it. You're done!